



Location Plan NTS

Please also refer to the following detailed planting proposal drawings as a set:

- 867/100 (Sheet 1 of 5)
- 867/101 (Sheet 2 of 5)
- 867/102 (Sheet 3 of 5)
- 867/103 (Sheet 4 of 5)
- 867/104 (Sheet 5 of 5) Includes Planting Schedule and Outline Specification

Key

	Site Boundary
	Existing Trees to be Retained and Protected to BS5837:2012 during Works. Dashed circle denotes Root Protection Area
	Extent of Required Tree Protection Fencing to BS5837:2012 as noted in Arboricultural Report, 2013, by Elliot Consultancy Ltd
	Existing Trees/Shrub Groups to be Retained and Protected to BS5837:2012 during Works
	Proposed Semi Mature Tree (25cm girth min.)
	Proposed Semi Mature Tree (25cm girth min.) to be planted with Root Barrier
	Proposed Extra Heavy Standard Tree (14-16cm girth)
	Proposed Extra Heavy Standard Tree (14-16cm girth) to be planted with Root Barrier
	Proposed Specimen Shrubs (10-15L pot)
	Proposed Hedge (5 plants/m, double staggered rows)
	Proposed Ornamental Shrub Planting
	Proposed Group of Herbaceous Plants
	Proposed Bulb Planting
	Proposed Turf to Private Front Gardens
	Back gardens are to be rotovetted, stone picked and laid with 150mm min. depth top soil prior to seeding with amenity grass seed

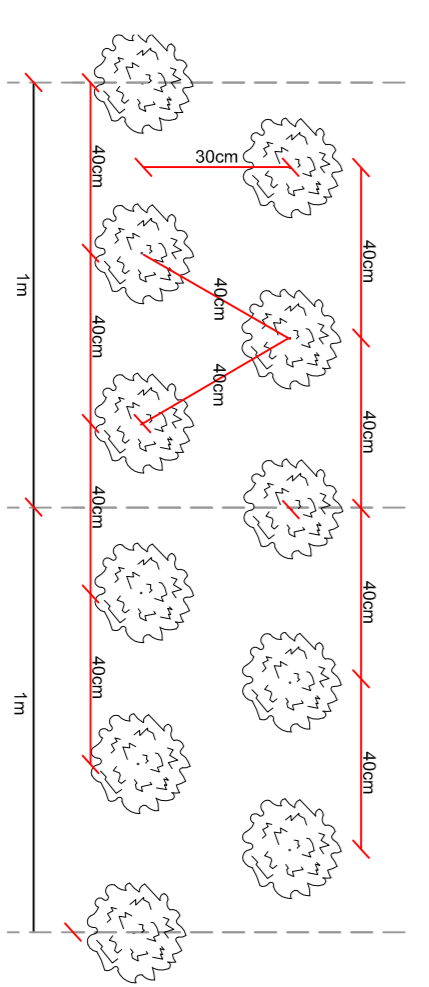
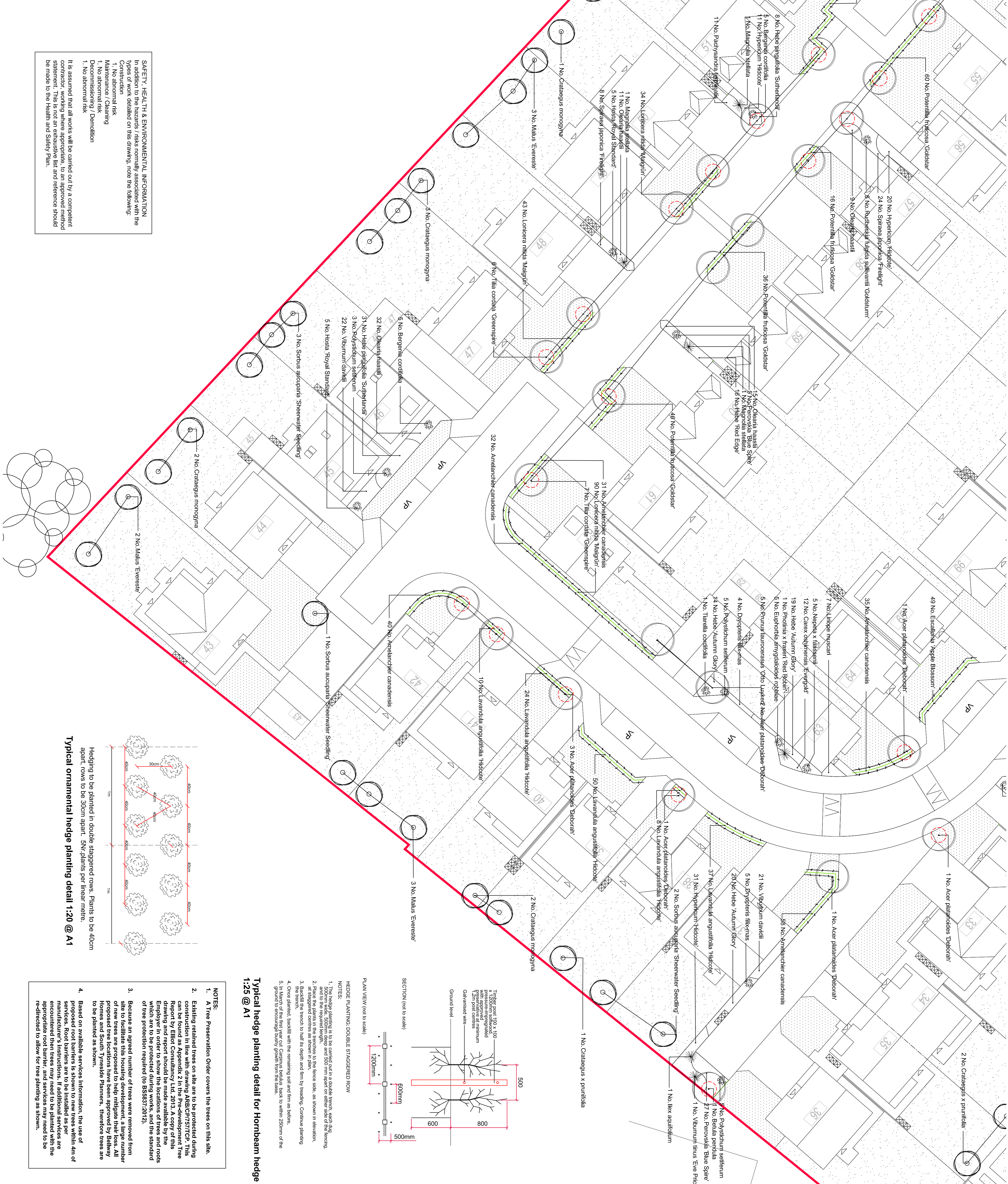

Typical ornamental hedge planting detail 1:20 @ A1

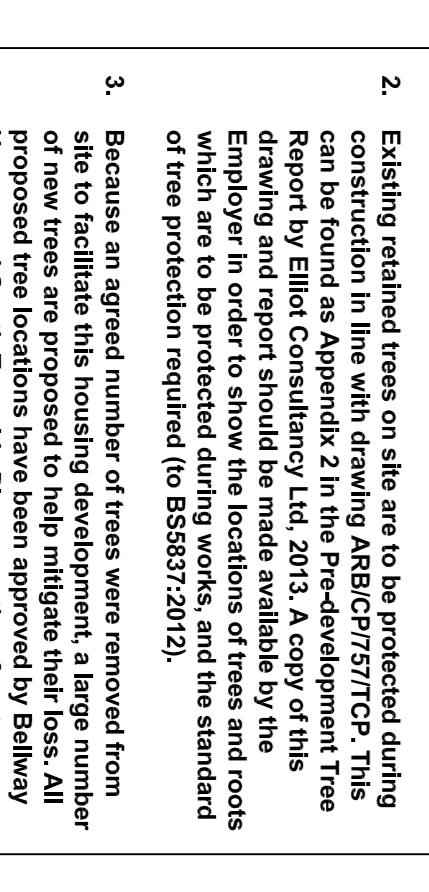

Typical hedge planting detail for Hornbeam hedge 1:25 @ A1

- NOTES:**
1. A Tree Preservation Order covers the trees on this site.
 2. Existing retained trees on site are to be protected during construction in line with drawing ARB/CP/75/TCF. This can be found as Appendix 2 in the Pre-development Tree Report by Elliot Consultancy Ltd, 2013. A copy of this report is available on the project website.
 3. Because an agreed number of trees were removed from site to facilitate this housing development, a large number of new trees are proposed to help mitigate their loss. All proposed tree locations have been approved by Bellway Homes and South Tyneside Planners, therefore trees are to be planted as shown.
 4. Based on available services information, the use of proposed root barriers is shown to new trees within 4m of services. Root barriers are to be installed as per manufacturer's instructions. If additional services are encountered then trees may need to be planted with the appropriate root barrier, and services may need to be re-directed to allow for tree planting as shown.

SAFETY, HEALTH & ENVIRONMENTAL INFORMATION
In addition to the hazards / risks normally associated with the types of work detailed on this drawing, note the following:

Construction
1. No abnormal risk
Maintenance / Cleaning
1. No abnormal risk
Decommissioning / Demolition
1. No abnormal risk

It is assumed that all works will be carried out by a competent contractor, working where appropriate, to an approved method statement. This is not an exhaustive list and reference should be made to the Health and Safety Plan.

Client:		Bellway Homes	
Dwg:		Detailed Planting Proposals (Sheet 3 of 5)	
Scale:	1:200@A1	Date:	06/15
Drawing No.:	867/102	Rev.:	
Proj.:		SOUTH TYNESIDE COLLEGE	
CDM:	By:	CP:	RS:
Loc.:	NE31	CM:	07/15
Drawn By:		Checked By:	
Date:		Date:	

